

USN



Seventh Semester B.E. Degree Examination, Dec.2024/Jan.2025
Quantity Surveying and Contract Management

Time: 3 hrs.

Max. Marks: 100

Note: Answer any FIVE full questions, choosing ONE full question from each module.

Module-1

- 1 a. List types of estimates and explain any one. (10 Marks)
- b. What is meant by estimation? List the purpose of estimation. (10 Marks)

OR

- 2 The details of a residential building are shown in Fig. Q2. Estimate the quantities of the following items of work and cost of the respective items in an abstract form :
 - a. Earthwork excavation for the foundation @ the rate of Rs 320/m³.
 - b. Size stone masonry in CM 1 : 6 for footing and plinth at the rate of Rs 2200/m³.
 - c. First class brick work in CM 1 : 5 for super structure @ Rs 3800/m³. Wall thickness 30cm. (20 Marks)

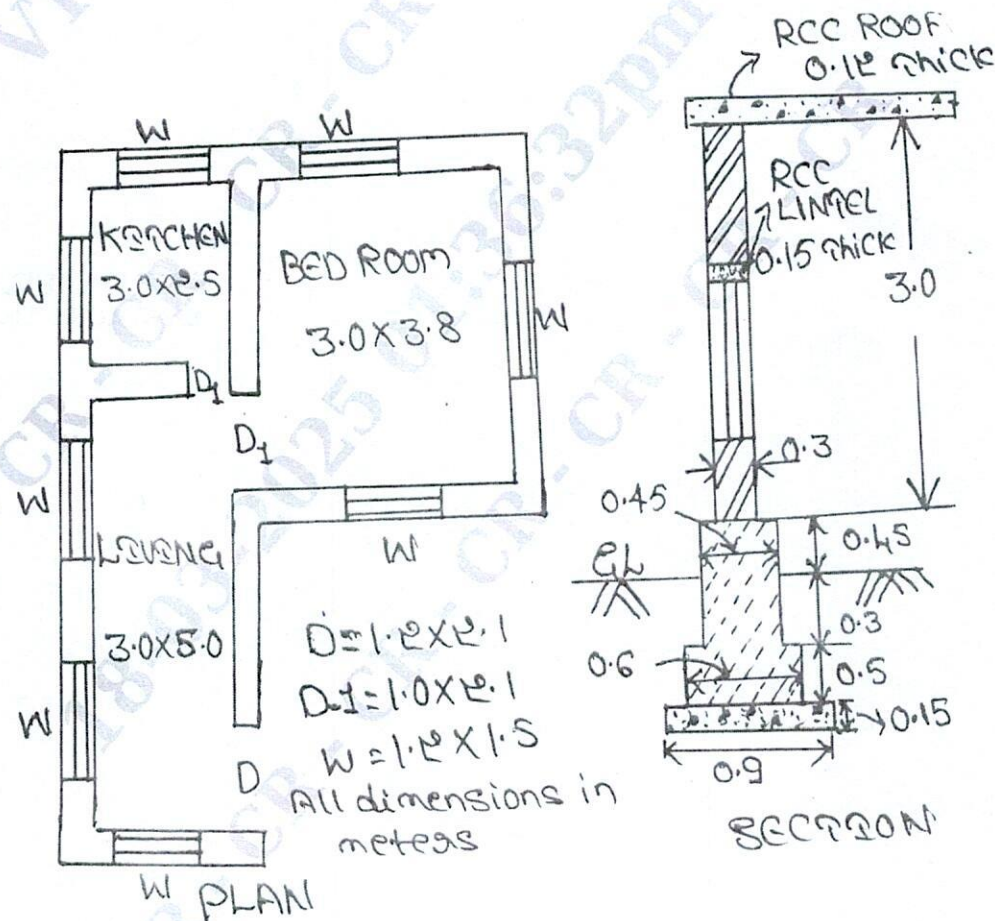

Fig. Q2

Module-2

- 3 The details of manhole is as shown in Fig. Q3. Estimate the quantities for the following item of work.
 - a. Earth work excavation in foundation.
 - b. Cement concrete 1 : 3 : 6 floor and foundation.
 - c. First class Brick work with CM 1 : 4.
 - d. 20mm thick cement plaster 1 : 3 in floor and channel. (20 Marks)

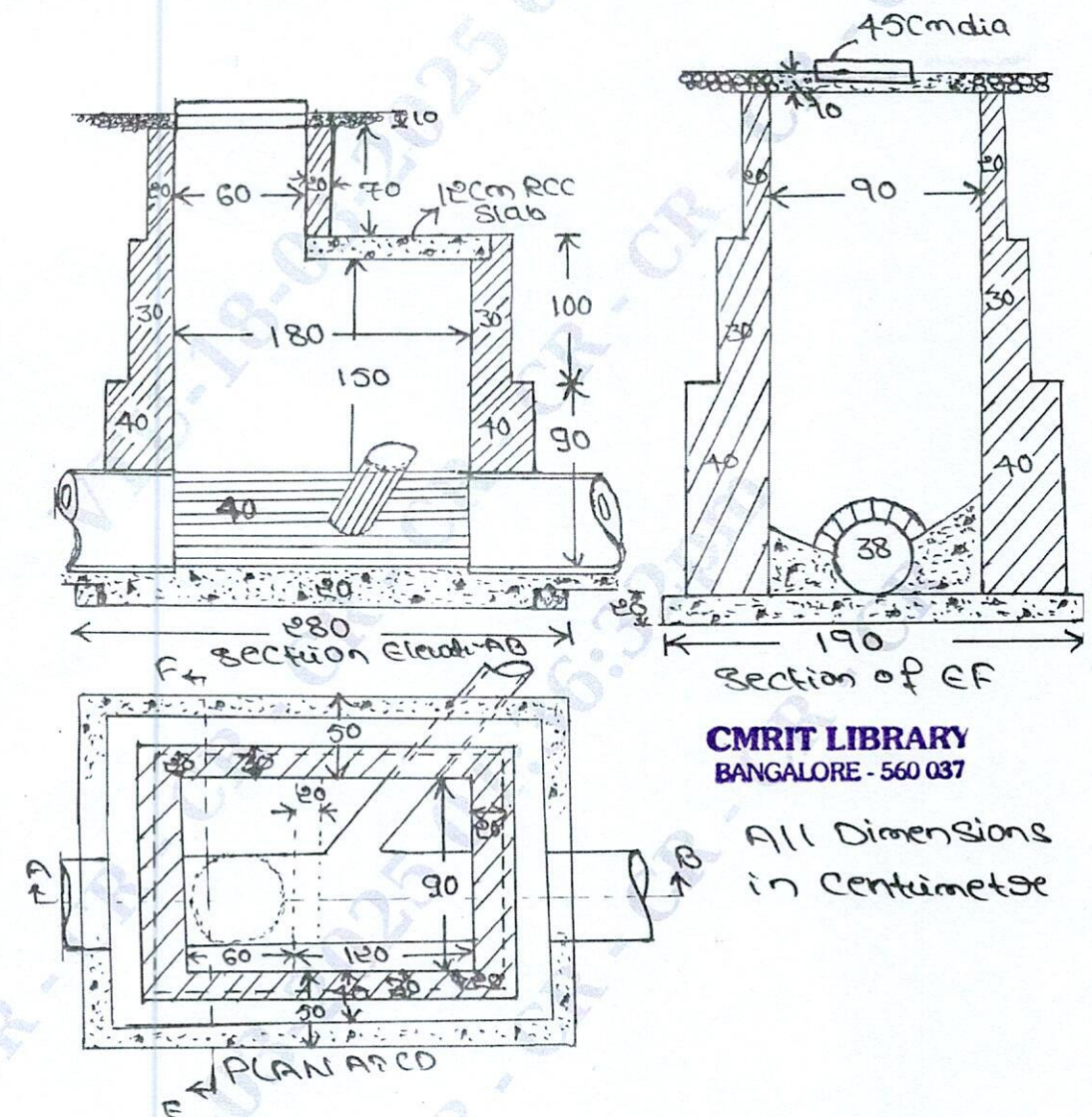

Fig. Q3

OR

- 4 Prepare a detailed estimate for earthwork for a portion of a road from the following data :

Dist (m)	0	100	200	300	400	500	600	700	800	900	1000	1100	1200
RL of ground	114.50	114.75	115.25	115.20	116.10	116.85	118.00	118.25	118.10	117.80	117.75	117.90	119.50
RL of formation	115.00	Upward Gradient 1 in 200						Downward Gradient 1 in 400					

Formation width of road is 10m side slope 2 : 1 in banking and $1\frac{1}{2}$: 1 in cutting Adopt suitable rates. (20 Marks)

Module-3

- 5 Analyse rates from first principle for following :
- 12mm thick cement plastering in CM 1 : 6.
 - Burnt Brick Masonry (BBM) for super structure in CM 1 : 6.
 - Lime concrete in Foundation with 40 mm gauge Brick Ballast.
 - 2.5 cm Cement concrete floor 1 : 2 : 4.
- (20 Marks)

OR

- 6 Write detailed specification for following :
- Burnt brick masonry for super structure in CM 1 : 6.
 - Ashlar Stone Masonry in CM 1 : 6.
 - 2.5cm thick cement concrete flooring 1 : 2 : 4.
 - RCC work proportion 1 : 2 : 4.
- (20 Marks)

Module-4

- 7 What are the features of FIDIC contract forms? (20 Marks)

CMRIT LIBRARY
BANGALORE - 560 037

OR

- 8 a. Write short note on :
- Administrative approval
 - Technical sanction.
- (10 Marks)
- b. Explain any two types of Contract. (10 Marks)

Module-5

- 9 Explain following terms :
- Performance security
 - Mobilization advance.
 - Secured advance
 - Liquidated damages.
- (20 Marks)

OR

- 10 a. What is meant by Valuation? List the purpose of valuation. (10 Marks)
- b. Write a short note on depreciation and list different methods of depreciation. (10 Marks)
